

## MOTORHOMES 2020





#inspiringadventures

So many adventures,  
so many stories.







Watch Adria Movie at  
[WWW.ADRIA.CO.UK](http://WWW.ADRIA.CO.UK)

**Living in Motion** is not just a philosophy at Adria, it's a way of life. We believe that travelling enriches the soul and provides a narrative to our ever more hectic daily lives. Our new season 2020 vehicles are designed with adventures in mind. New models, new layouts and detailed improvements across the range. Manufactured at our state of the art production facilities, supported by class-leading warranties, our Adria dealers in Great Britain and over 500 Adria dealers across Europe and beyond, the Adria badge is your assurance of quality on your travels. All of our caravans are designed for living and designed to perform.

So many adventures, so many stories to be enjoyed.

**Sonja Gole**, General Manager, Adria Mobil







Watch the factory movie at:  
[www.adria.co.uk](http://www.adria.co.uk)





Adria caravans regularly win independent awards for design, innovation, quality and value for money. Discover the Adria factory movie at [www.adria.co.uk](http://www.adria.co.uk)



# Why choose Adria?

There are, of course, many brands to choose from, but the reasons for choosing Adria have never been so compelling.



## **PASSION & EXPERIENCE**

Adria has been designing and manufacturing leisure vehicles for over fifty years.

## **INTELLIGENT DESIGN**

Adria leads in intelligent design, which optimizes the use of technology, the best construction methods and materials.

## **WORLD-CLASS MANUFACTURING**

The most advanced production facilities in the industry, ISO 9001, 14001 & EFQM 5 star certified for business excellence, quality management & environmental standards.

## **QUALITY**

Adria motorhomes have a reputation for quality, reliability and durability using proven automotive manufacturing techniques. We make most of our own furniture and quality control the entire vehicle manufacturing process.

## **PEACE OF MIND**

Adria motorhomes come with a class-leading warranty and the support of our dealers in Great Britain and over 500 Adria dealers across Europe and beyond, backed up by a world-class parts supply and aftersales service.







# Designed for living

**DETAILS MATTER.** Our motorhomes are designed for living, where the details matter and every centimetre counts. The science of layouts and construction, so that everything is in the right place, is learned over decades and Adria brings this experience to every layout. For this season we have also redesigned all internal lighting and improved the comfort of our mattresses & seating.

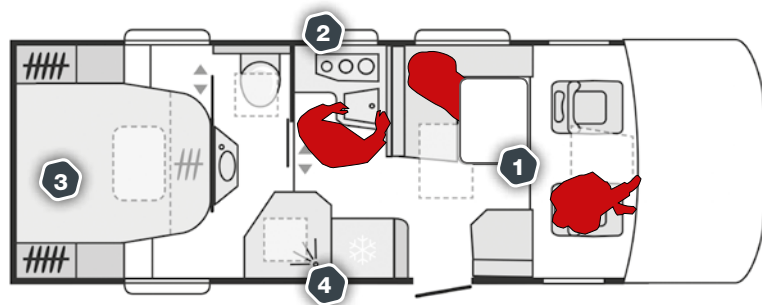

## 1 | LIVING

Contemporary interior design and a wide choice of layouts and finishes.

## 2 | KITCHENS

Intelligently-designed kitchens with style and functionality, matched with the best appliances.

## 3 | BEDROOMS

2, 4, 5 and 6 berth layouts to suit all users, with a wide range of bed formats.



## 4 | BATHROOMS

A wide choice of bathroom solutions, including en-suite, & new swivelling door format.

## 5 | STORAGE

New garage design and optimized storage throughout.

## 6 | MULTI-MEDIA

Smart solutions.







Our wealth of experience in motorhome design means great living spaces in all models. Always comfortable and practical, with natural and new design lighting.





# NEW TRENDS, NEW LAYOUTS

Our wealth of experience in motorhome design means great living spaces in all models. Always comfortable and practical, with natural and controllable lighting.



Open Salon



L-Dinette



Shorter layouts

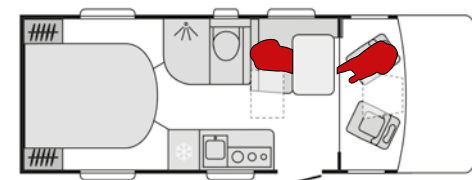
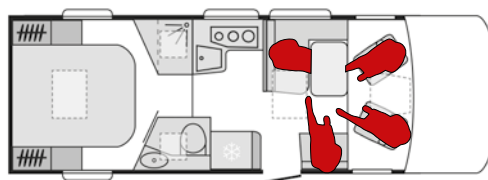
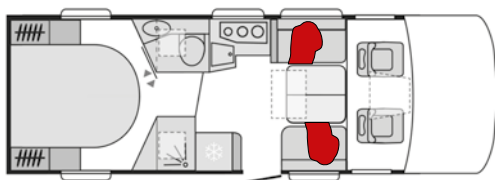





Please note that right hand drive models are standard for the UK market.







Our kitchens are ergonomically designed with everything in the right place and the best appliances.









A wide choice of layouts and sleeping solutions, all with easy to access beds with optimised dimensions, controllable lighting and with new more comfortable mattresses.

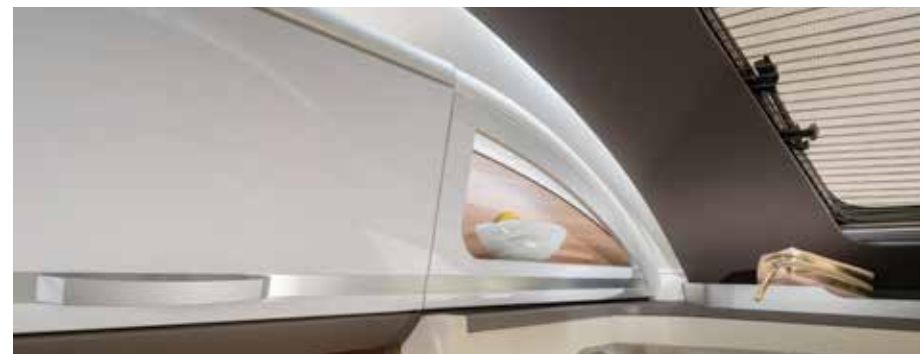

# EVERY ADVENTURE STARTS WITH A GREAT NIGHT'S SLEEP

We care about your sleep. On holiday a great night's sleep shouldn't be a luxury, it should be an everyday pleasure. Wake up each morning refreshed and energized for the new day's adventures.



Our new Luxe mattresses offer premium quality comfort and support. Featuring high resistance foam construction, easy-care fabric and natural protection against bacteria, odours and static.



### FABRIC



AIR KNITTED FABRIC



ZIPPER



WASHABLE 40°



DRYING ON AIR  
(NOT IN MACHINE)

### SILVER PROTECTION



100 % NATURAL



NON-TOXIC



ANTIBACTERIAL



ANTI-ODOR



ANTI-STATIC





Experience even more comfort with our new bedroom layouts in Sonic, Coral and Matrix. New lighting, new ambiance and a new wall linings.



Please check [www.adria.co.uk](http://www.adria.co.uk)  
for individual model specifications.







Bathrooms designed on ergonomic principles, also in a range of formats, including our new Duplex bathroom with swivelling wall.





**SMART LIVING.** Live smart, with sensible TV holder placement, USB sockets, Bluetooth amplifiers and simple to use digital controllers.







**SMART LIGHTING.** New lighting systems in all vehicles, with controllable ambiance at your fingertips.





**SMART SOLUTIONS.** Places for all your clothes and holiday gear, with innovative storage solutions throughout each vehicle.

\*Some features shown may not be available on all models.







**SMART STORAGE.** New design garages and innovative storage solutions throughout each motorhome.

\*Some features may not be available on all models.



# Designed to perform

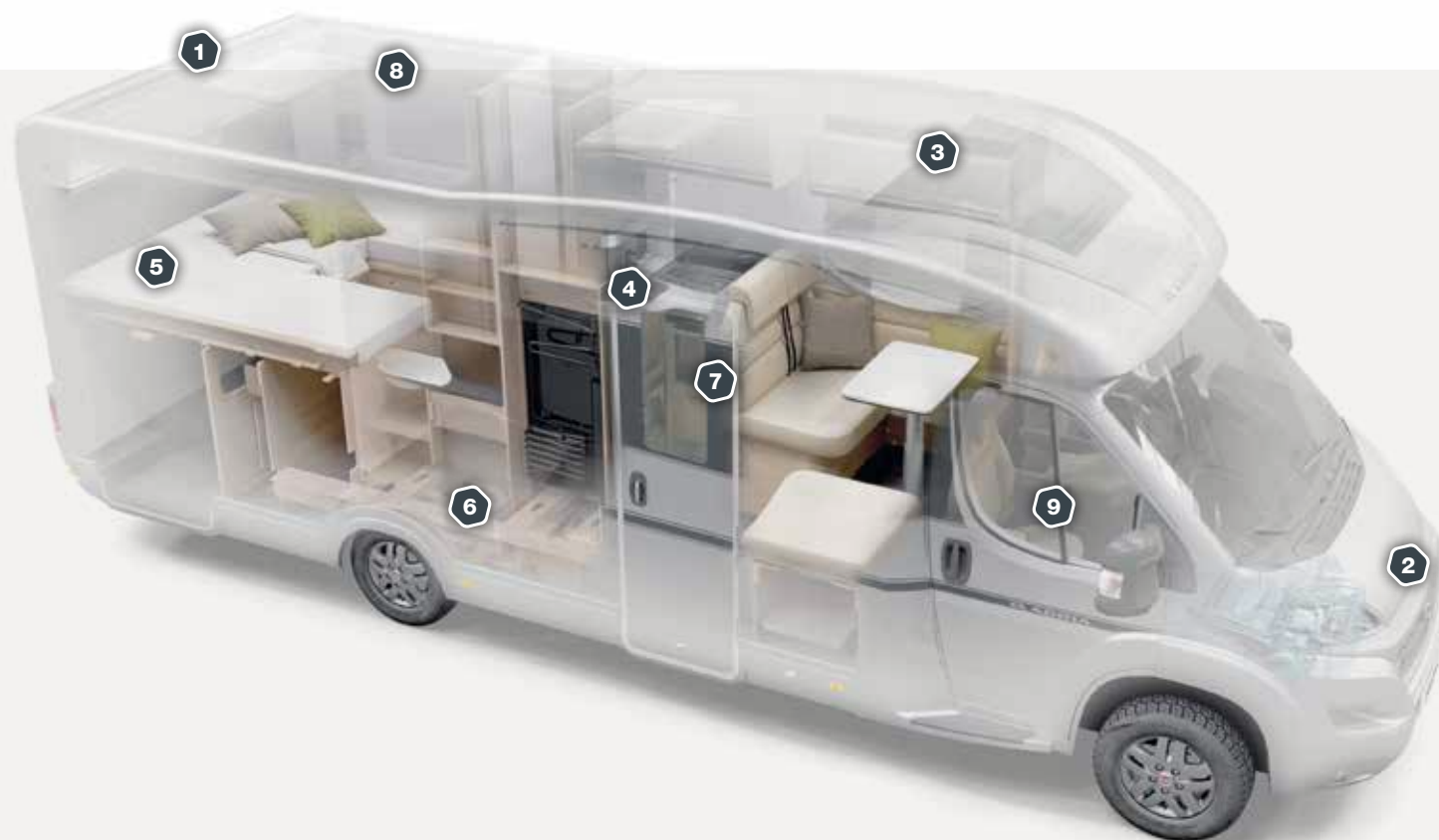

**2**  
YEAR\* ADRIA  
warranty

**10**

**10**  
YEAR\* ADRIA  
WATER INGRESS  
warranty

\*Terms & Conditions apply,  
see website for details.



# REAL WORLD PERFORMANCE

All Adria motorhomes are also designed to perform. Everything is meticulously designed, developed and tested to ensure your safety, comfort and enjoyment. Built to enjoy, built to last.



## 1. INTELLIGENT DESIGN

Aero-dynamic exterior styling with dynamic front profiles and rear walls and integrated features such as new LED lighting. The seamless integration of interior space and choice of contemporary interiors, layouts and features.

## 2. BASE VEHICLES

Perfect integration with the acclaimed Fiat Ducato base vehicle with the latest Euro6 engines and range of driver aids.

## 3. BODY CONSTRUCTION

Adria's unique 'Comprex' body construction combines the torsional strength of wood, the durability of polyester and the moisture-stopping properties of polyurethane. Our motorhomes come with a 10 year Water Ingress Warranty.\*

## 4. CLIMATE CONTROL

Designed for living all year round, with optimized heating efficiency by Truma or Alde central heating, engineered and tested to extremes in our climatic chamber.

## 5. INSULATION

The latest thermal insulation materials, sophisticated heat and air flow management to Adria's 'Thermo-build' standards.

## 6. AIR-FLOW

Adria's sophisticated Air Flow System means every vehicle has integrated air-flow and ventilation, with no cold-spots.

## 7. WINDOWS & DOORS

The largest and most advanced panoramic windows and Sky-roofs available, with built-in features. Integrated windows and doors ensure optimum natural lighting, ventilation, privacy and security.

## 8. FURNITURE & STORAGE

Craftsman-built cabinetry integrated with heating and air-flow for optimum thermal efficiency. Plenty of flexible storage throughout each vehicle for all your gear too.

## 9. COMFORT & SAFETY

The combination of contemporary interior design, optimized space, functionality and ergonomically designed living spaces. The maximum permitted seat belt and Isofix options too.

## 10. CUSTOMER SERVICE

Class-leading 2 Year General Warranty and 10 Year Water Ingress Warranty as standard\*, the support of Adria dealers and an efficient after sales and parts service.

# CONSTRUCTION

Adria's 'Comprex' construction which combines the torsional strength of wood, the durability of polyurethane and the moisture-stopping properties of polyester.



Our state of the art factory includes plasma-treat technology. It's a robotized process which cleans and applies adhesive to ensure perfect sealing of window and door joints.

- 1 | COMPOSITE WOOD PANEL
- 2 | POLYURETHANE SEALING
- 3 | EPS STYROFOAM
- 4 | EXTERIOR POLYESTER  
BODY SHELL CLADDING (sidewall)
- 5 | EXTERIOR POLYESTER  
BODY SHELL CLADDING (floor)
- 6 | REINFORCED HARDWOOD PROFILE
- 7 | XPS STYROFOAM INSULATION FOAM

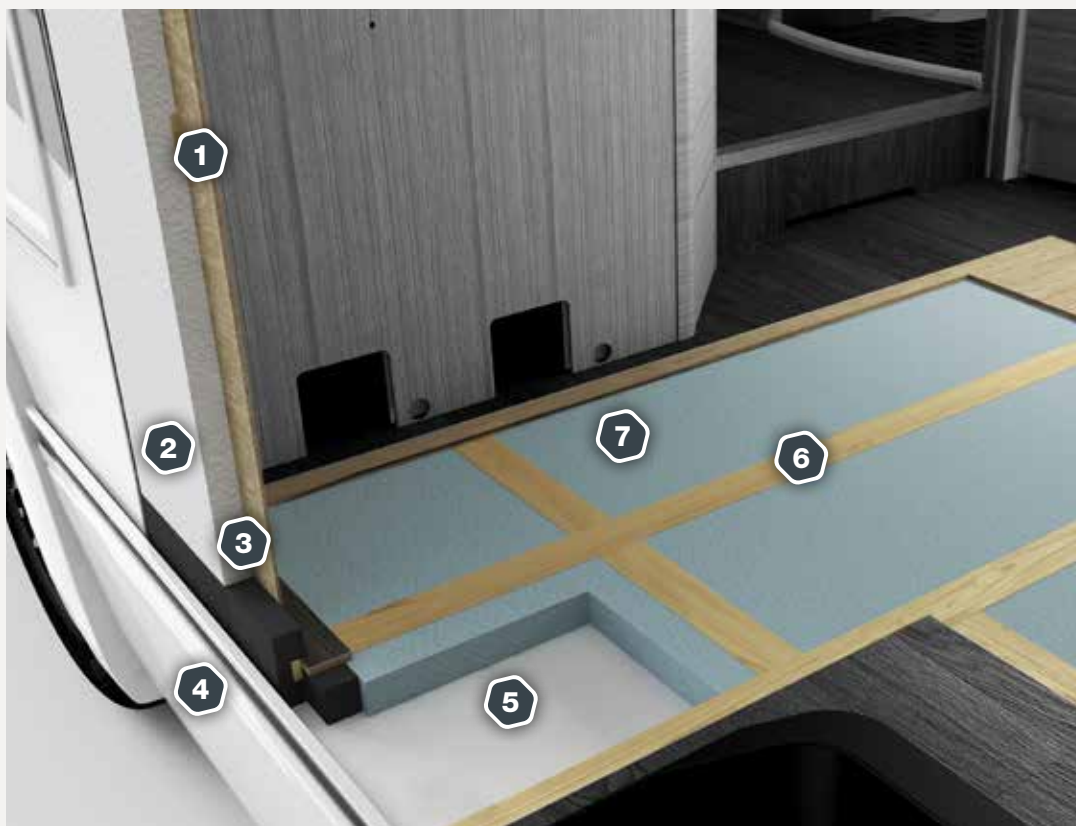

\*Terms & Conditions apply,  
see website for details.



# CLIMATE CONTROL

**ADRIA THERMO-BUILD STANDARDS.** All Adria motorhomes are built to 'Thermo-build' standards, with optimized insulation materials, precisely engineered heating design and Adria's Air Flow System which integrates the flow of air through the vehicle. This means all our motorhomes are suitable for use all year round. All vehicles are tested in our own climate chamber, from -40 to +60 degrees and in humidity from 45 % to 80 % between +30 and +60 degrees.

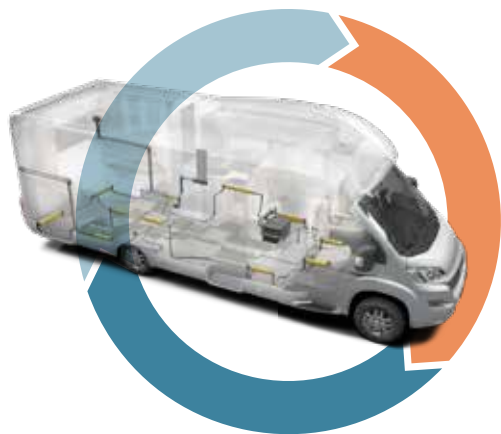

**VENTILATION COOLING.** Comfort is assured in warmer conditions too with optional factoryfitted air conditioning and good ventilation and shading integrated into our vehicle designs, including thermo-shielding and integrated screens in our sky-roof panoramic windows.

**\*some features may not be available on all models.**



**truma**



**Alde**

**HEATING.** We offer the best heating systems and test our vehicles to extremes in temperature and humidity in our own climatic chamber. We offer Truma heating, easy to use warm air distribution system with optional electrical underfloor heating. On selected models we offer Alde integrated heating, which is a liquid based central heating system, distributing heat evenly through the floor.

# BASE VEHICLES

## VEHICLE CHASSIS

**WE CHOOSE THE BEST CHASSIS FOR EACH VEHICLE FOR THE BEST TORSIONAL STRENGTH, PERFORMANCE DYNAMICS AND INTERIOR LIVING SPACE DESIGN.**

### **AL-KO HIGH PROFILE CHASSIS.**

Sonic Supremes offer this chassis for optimum torsional strength and interior living space design. AL-KO Air Premium, AL-KO level controller are also available as options on Sonic Supreme models.



**FIAT DUCATO CHASSIS.** We choose the best chassis for each vehicle for the best torsional strength and interior living space design, including the Fiat chassis on selected models:

- Rigid rear axle with longitudinal parabolic leaf springs, telescopic dampers and flexible side blocks.

- Up-to 4,400 kg MPTLM.



# FIAT DUCATO



EURO 6.d

2,3 | **140 HP**

2,3 | **160 HP**

2,3 | **180 HP**



The leading base vehicle from Fiat offers a range of class-leading features:

- Automotive style exterior in up-to three exterior colours.
- Automotive style cabin interior with 'Captain's chairs' and two styles.
- Air-conditioning.
- Electronically controlled Multi-jet 2,3l common rail direct injection Euro6 engines.
- Choice of 140Hp, 160Hp or 180Hp engines (dependent on Adria model).
- Best-in-class 6-speed manual or new 9-speed automatic gearbox\*
- ESP Electronic Stability Program now as stand.ard.
- Stop & Start (standard on 160Hp,180Hp)
- Driver aids including practical Tablet/Smart phone holder with USB connector.
- 60 or 75l fuel tank dependent on model (optional 90l tank).





Options include:

- Infotainment including Bluetooth radios, MP3 and integrated navigation options.
- Electronic Stability Control (ESC).
- Speed Limiter & Traction and Hill Descent Control.
- Full Brake Control (not on Sonic).
- Towing hook.
- Rear view reversing camera.
- Parking sensors (on selected models).

Please check [www.adria.co.uk](http://www.adria.co.uk) for individual model specifications and technical details.

\* available on selected Adria models

\*\* Some features may not be available on all models. Please check [www.adria.co.uk](http://www.adria.co.uk) for individual model specifications and technical details.

## PERFECTLY INTEGRATED



Motorhomes perfectly integrated on the Fiat Ducato, with latest Euro 6 engines, now with AdBlue, turbocharger and air cooler intake, with improved torque, performance and lower emissions.

# 2020 Season highlights

## THE PERFECT MOTORHOME FOR YOU

Experience the best in contemporary motorhome design and with our widest ever offer, there's sure to be the perfect motorhome for you.

## NEW COMPACT. GO ANYWHERE!

The new Compact, with slim-fit and short length dimensions for an agile motorhome, which can reach more places.

Now available in new Supreme and Plus models. All models with contemporary new interiors, high levels of specification, comfort and practicality. Supreme models with 'silver' body and exclusive new Sky-roof and Sky-lounge.



## MORE COMFORT

New lighting, new ambiance and new soft furnishings across each range. Bedrooms with new layouts, new mattresses.







## NEW LAYOUTS

We offer a wide range of layouts from classical L-dinette, to Open Salon and new Short layouts with exclusive new bedroom and bathroom solutions.

## IMPROVED PERFORMANCE

Our new season motorhomes offer improved base vehicles from Fiat, with higher performance Euro6 engine choices and more driver aids.



## GARAGE RENOVATION

We have renovated our garages for easier access, new lighting, more storage possibilities and other improvements.

# Motorhomes

PAGE  
**34** A CLASS

40 SONIC  
— SUPREME

42 SONIC  
— AXESS



PAGE  
**48** CROSSOVER

54 MATRIX  
— SUPREME

54 MATRIX  
— PLUS

56 MATRIX  
— AXESS





PAGE  
62 LOW-PROFILE

68 CORAL  
— SUPREME

68 CORAL  
— PLUS

70 CORAL  
— AXESS



PAGE  
76 OVER-CAB

80 CORAL XL  
— PLUS



PAGE  
84 COMPACT

88 COMPACT  
— SUPREME

88 COMPACT  
— PLUS



A CLASS



# Freedom to express yourself.

Our premium A-Class, Sonic motorhomes, offer the freedom not just to travel but to express yourself. Luxury tourers with high levels of specification, style, and practicality. New comfort with new mattresses, seating and lighting design. Available in Supreme and Axess models, on the Fiat Ducato, as 4 berth motorhome layouts.

**SONIC SUPREME**



**SONIC AXESS**





# SONIC RANGE

A CLASS



# SONIC

Sonic, a motorhome designed around the way you use it, with a purity of line, form and function. A harmonious, uncluttered design where everything is just 'right', where space is uncompromised and you have all the features you need in the right place and a perfect interior ambiance day or night.

## EXTERIOR FEATURES

1 . **ADRIA "COMPREX"**  
body construction.

2 . **SIDE-WINDOWS** and  
high-position mirrors for  
improved visibility.

3 . **PANORAMIC**  
roof window.

4 . **EXCLUSIVE FRONT  
MASK**, grill and automotive  
style details.

5 . **NEW INTEGRATED  
LED LIGHTS** (Supreme).

6 . **WIDE 600 mm** entrance  
door.

7 . **NEW GARAGE DESIGN**  
with lights, power and new  
storage solutions.

8 . **NEW SEITZ S4** framed  
windows.



### 360° WALKTHROUGH

Step inside Sonic, take a 360° Walkthrough on [www.adria.co.uk](http://www.adria.co.uk)



# INTERIOR FEATURES



**I** . Comfortable living room with new seating and lighting.

**II** . Contemporary interior design with choice of textiles and soft furnishings.

**III** . Large dinette with adjustable table and Isofix.

**IV** . Multi-media wall and touch-screen control with TV holder (22-28").

**V** . Light-frame electrically-operated front lift-down bed.

**VI** . New window lining in dinette (Supreme models).

**VII** . Concave design deep overhead cupboards.



## SONIC SUPREME — Symphony White





## SONIC AXESS \_ Tempo Brown



SONIC  
SUPREME





**Sonic Supreme.** The ultimate tourer in the range, with silver alu-metallic body and the most luxurious interior and highest specifications. Symphony White interior design with new lighting and a choice of textiles and soft-furnishings.

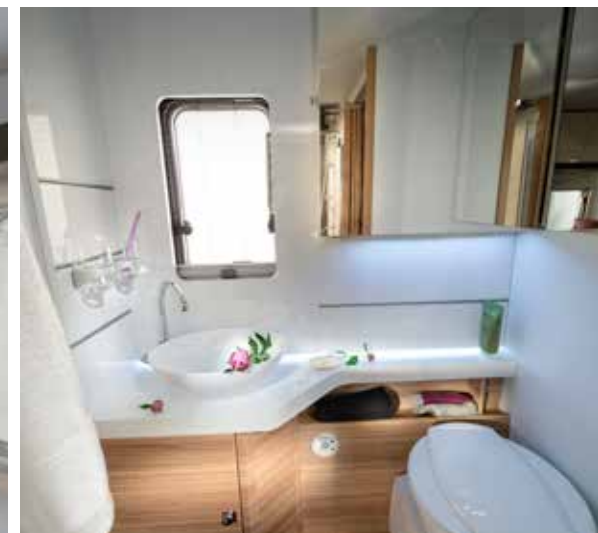
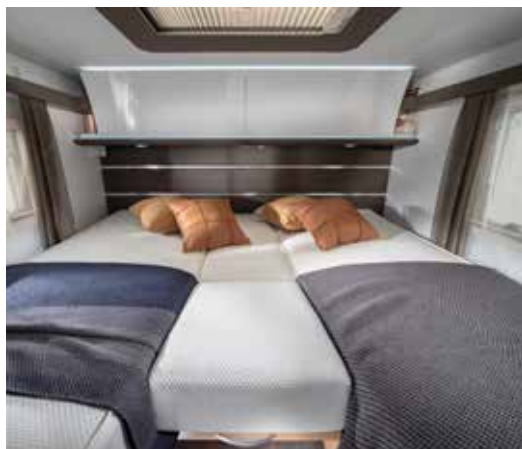

SYMPHONY WHITE

Please note that right hand drive models are standard for the UK market.

SONIC  
AXESS





**Sonic Axess.** The entry-level tourer in the range, with white body, new interior and good specifications. Tempo Brown interior design with new lighting.



TEMPO BROWN

Please note that right hand drive models are standard for the UK market.

# SONIC A CLASS

## Layouts

SONIC SUPREME

**710 DC** L (mm) **7520**  
4 4 W (mm) **2320**

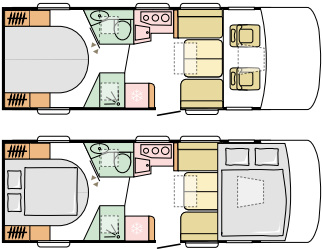

**710 SC** L (mm) **7520**  
4 3 W (mm) **2320**

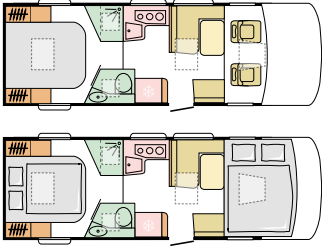

**710 SL** L (mm) **7520**  
4 3 W (mm) **2320**

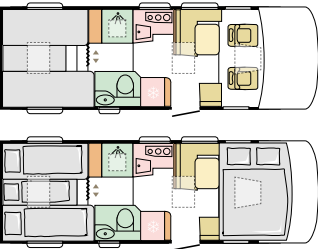

**810 SC** L (mm) **8800**  
4 4 W (mm) **2320**

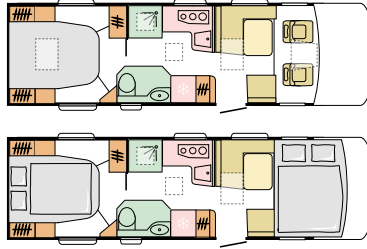

**810 SL** L (mm) **8800**  
4 4 W (mm) **2320**

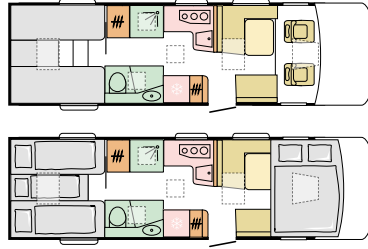

SONIC AXESS

**600 SL** L (mm) **6990**  
4 4 W (mm) **2320**

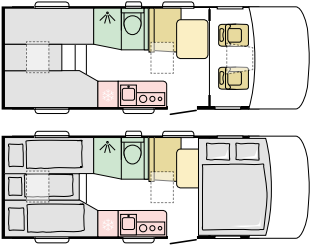

L = Length W = Width



## Key data



**LENGTH** 7520 - 8800 mm  
**WIDTH** 2320 mm  
**HEIGHT** 2960 - 2980 mm  
**WEIGHT** 4400 - 5000 kg  
**ENGINE** 2,3 180 HP



## Key features

- Adria exclusive styling with silver metallic alu body and panoramic window.
- Adria 'Comprex' body construction on AL-KO high profile chassis.
- Symphony White interior design with choice of textiles & new soft furnishings.
- 'S Line' kitchen with 167 l fridge, 3 burner stove and oven.
- Luxurious rear bedroom and electrically operated front lift-down bed.
- Alde heating.
- Factory-fitted accessories options.

SONIC SUPREME



**LENGTH** 6990 mm  
**WIDTH** 2320 mm  
**HEIGHT** 2960 - 2980 mm  
**WEIGHT** 3500 - 4400 kg  
**ENGINE** 2,3 140 / 160 / 180 HP



- Adria exclusive styling white body and optional panoramic window.
- Adria 'Comprex' body construction on Fiat High Profile chassis.
- New Tempo Brown interior design with choice of textiles and new soft furnishings.
- 'S Line' kitchen with 142 l fridge, 3 burner stove and optional oven.
- Luxurious rear bedroom and electrically operated front lift-down bed.
- Truma heating.
- Factory-fitted accessories options.

SONIC AXESS

SONIC A CLASS



SUPREME



SILVER METALLIC



SYMPHONY WHITE

AXESS



WHITE



TEMPO BROWN



STANDARD FABRIC SELECTION



UPHOLSTERY



SEWING STYLE



ZANNA



ZANNA

OPTIONAL FABRIC SELECTION



LEATHER MATHISSE



LEATHER EDWARD



LEATHER MATHISSE



LEATHER EDWARD



\* With your choice of textile you can select any decorative cushion set.

## CROSSOVER



# More style. More versatile.

Our sleek and capable crossover motorhome range, Matrix, offers so much style and versatility. Setting the benchmark for the category, with high levels of specification, comfort and practicality. Available in Supreme, Plus and Axess models, as 4 and 5 berth motorhome layouts.

**MATRIX SUPREME**



**MATRIX PLUS**



**MATRIX AXESS**





# MATRIX RANGE

CROSSOVER





## EXTERIOR FEATURES

1 . **ADRIA 'COMPREX'** body construction.

2 . **AERO-DYNAMIC** exterior profile with panoramic roof window.

3 . **DYNAMIC REAR WALL** with new LED lights (on Supreme).

4 . **CHOICE OF BODY COLOURS** (silver on Supreme, white on Plus and Axess).

5 . **AUTOMOTIVE SIDE-SKIRT** with optional cabin step.

6 . **WIDE 600 mm ENTRANCE** door.

7 . **EASY ACCESS**, new garage design with lights, power and new storage solutions.

8 . **NEW SEITZ S4** framed windows.



### 360° WALKTHROUGH

Step inside Matrix, take a 360° Walkthrough on [www.adria.co.uk](http://www.adria.co.uk)

# INTERIOR FEATURES

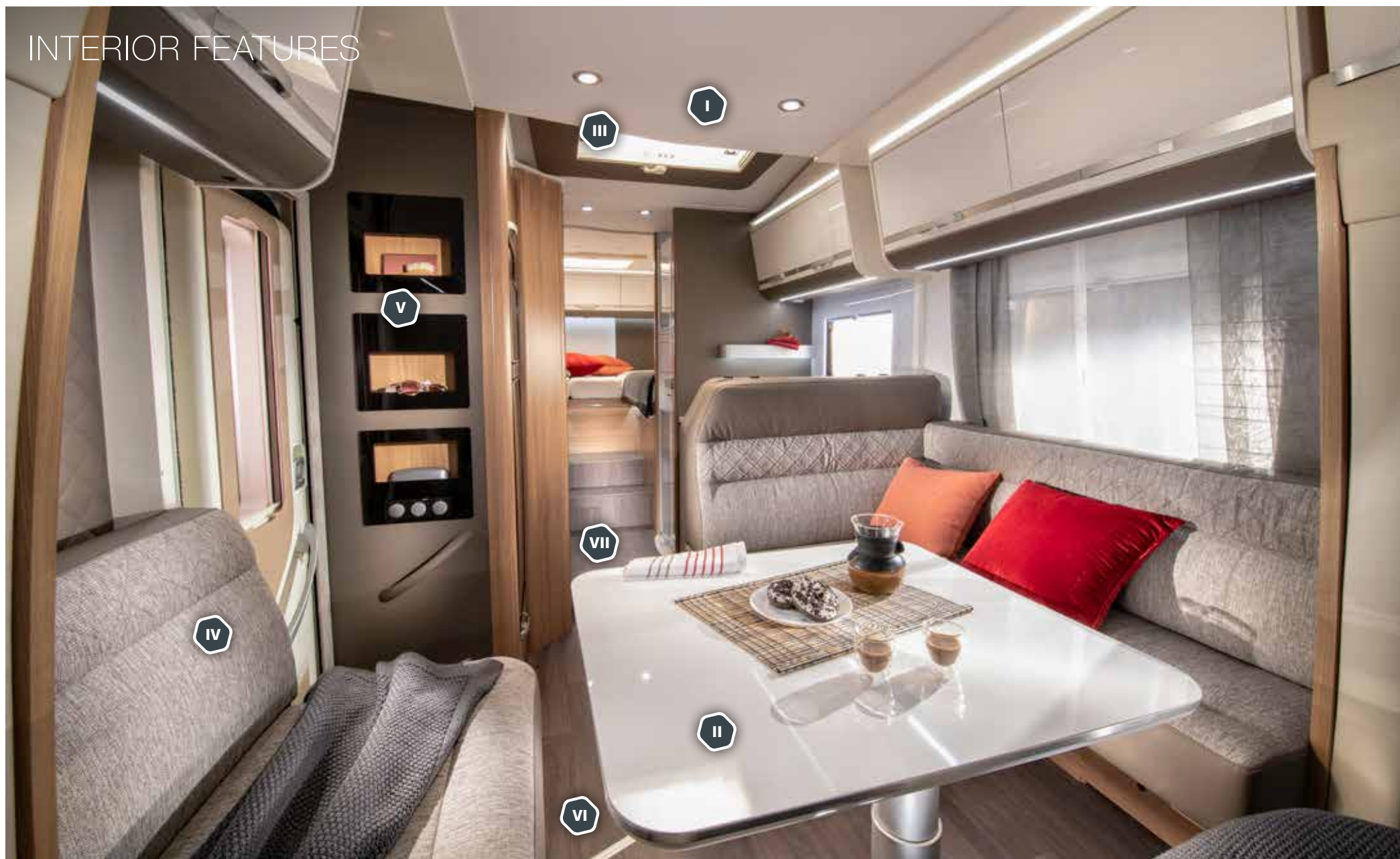

**I** . Light-frame electrically operated front lift-down bed.

**II** . Large dinette with Isofix and up-to 5 homologated seats.

**III** . Panoramic and roof windows and new lighter colour ceiling.

**IV** . Contemporary interior design with choice of textiles and soft furnishing.

**V** . Multi-media wall and touch screen control panel.

**VI** . Double floor in dinette with heating and storage solution.

**VII** . Choice of Truma or Alde heating.





## MATRIX SUPREME / PLUS \_ Symphony White



MATRIX AXESS \_ Tempo Brown





MATRIX  
SUPREME

MATRIX  
PLUS



**Matrix Supreme.** The ultimate crossover with silver alu-metallic body and the most luxurious interior and highest specifications. Symphony White interior design with new lighting and a choice of textiles and soft-furnishings.

**Matrix Plus.** The mid-level crossover, with white body and choice of cabin colour, contemporary interior and high specifications. Symphony White interior design with new lighting and a choice of textiles and soft-furnishings.



SYMPHONY WHITE

Please note that right hand drive models are standard for the UK market.





**Matrix Axess.** The entry-level crossover, with white body, contemporary interior and good specifications. Tempo Brown interior design with new lighting.



TEMPO BROWN

Please note that right hand drive models are standard for the UK market.



# MATRIX CROSSOVER

## Layouts

MATRIX SUPREME

**670 DC** L (mm) 7503  
4 4 W (mm) 2299

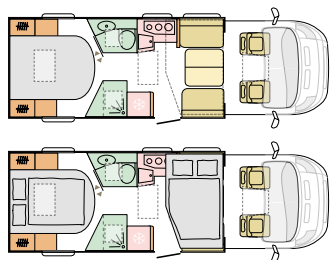

**670 DL** L (mm) 7503  
5 4 W (mm) 2299

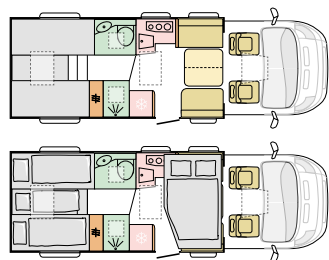

**670 SC** L (mm) 7503  
5 5 W (mm) 2299

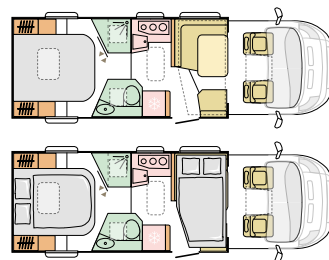

**670 SL** L (mm) 7383  
5 5 W (mm) 2299

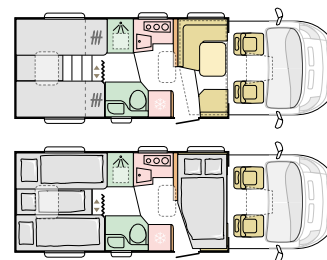

**670 SLT** L (mm) 7503  
5 5 W (mm) 2299

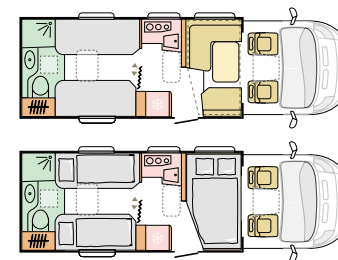

MATRIX PLUS

**600 DT** L (mm) 6999  
4 4 W (mm) 2299

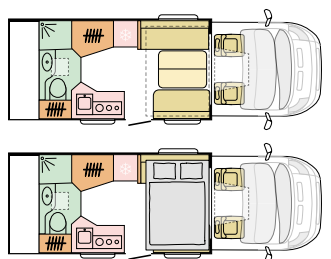

**670 DC** L (mm) 7503  
4 4 W (mm) 2299

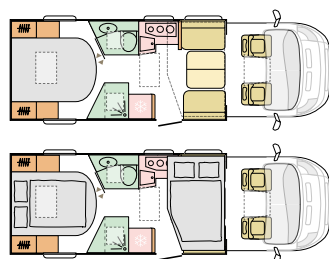

**670 DL** L (mm) 7503  
4 4 W (mm) 2299

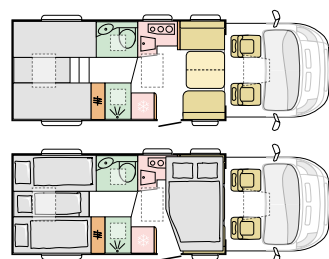

**670 SC** L (mm) 7503  
5 5 W (mm) 2299

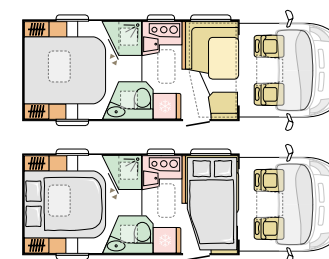

**670 SL** L (mm) 7383  
5 5 W (mm) 2299

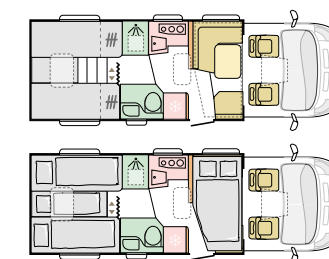

MATRIX AXESS

**520 ST** L (mm) 5969  
4 4 W (mm) 2299

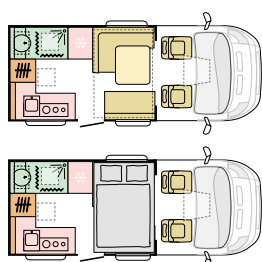

**600 SC** L (mm) 6999  
4 5 W (mm) 2299

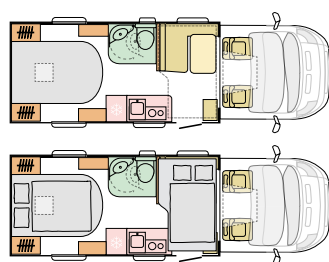

**600 SL** L (mm) 6999  
4 4 W (mm) 2299

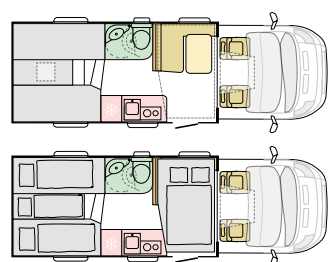

**670 SC** L (mm) 7503  
5 5 W (mm) 2299

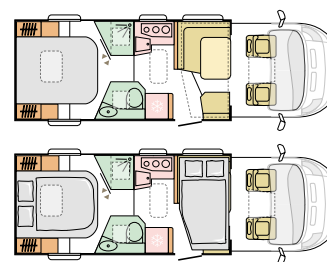

**670 SL** L (mm) 7383  
5 5 W (mm) 2299

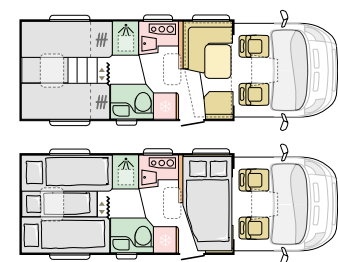

## Key data



**LENGTH** 7383 - 7503 mm  
**WIDTH** 2299 mm  
**HEIGHT** 2810 - 2855 mm  
**WEIGHT** 3500 - 4400 kg  
**ENGINE** 2,3 140 / 160 / 180 HP



or



\*available on Limited Edition models only

## Key features

- Adria 'Comprex' body construction, silver metallic alu body and panoramic window.
- Symphony White interior design with choice of textiles and new soft furnishings.
- Luxurious rear bedroom and electrically operated front lift-down bed.
- 'V design' kitchen with large fridge, 3 burner stove and oven.
- Spacious dinette on double floor with 5th homologated seat and Isofix.
- Multi-media wall and touch-screen control with TV holder.
- Alde Heating. Truma heating available on Limited Edition models only (ask your local dealer).
- Factory-fitted accessories options.

MATRIX SUPREME

**670 SLT** L (mm) **7503**

**5** **5** W (mm) **2299**

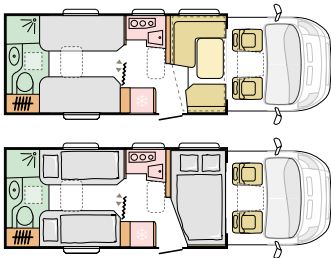

**LENGTH** 6999 - 7503 mm  
**WIDTH** 2299 mm  
**HEIGHT** 2810 mm  
**WEIGHT** 3500 - 4400 kg  
**ENGINE** 2,3 140 / 160 / 180 HP



- Adria 'Comprex' body construction, white body and panoramic window.
- Symphony White interior design with choice of textiles and new soft furnishings.
- Luxurious rear bedroom and electrically operated front lift-down bed.
- 'V design' kitchen with large fridge, 3 burner stove and oven.
- Spacious dinette on double floor with 5th homologated seat and Isofix.
- Multi-media wall and touch-screen control with TV holder.
- Truma or Alde heating.
- Factory-fitted accessories options.

MATRIX PLUS



**LENGTH** 5969 - 7503 mm  
**WIDTH** 2299 mm  
**HEIGHT** 2810 mm  
**WEIGHT** 3500 - 4000 kg  
**ENGINE** 2.3 / 140 / 160 / 180 HP



- Adria 'Comprex' body construction, white body and panoramic window.
- Tempo Brown interior design and new soft furnishings.
- Luxurious rear bedroom and electrically operated front lift-down bed.
- 'V design' kitchen with large fridge, three burner stove and oven.
- Spacious dinette on double floor with 5th homologated seat and Isofix.
- Multi-media wall and touch-screen control with TV holder.
- Truma heating.
- Factory-fitted accessories options.

MATRIX AXESS



# MATRIX CROSSOVER



## SUPREME



SILVER METALLIC



SYMPHONY WHITE

## PLUS



WHITE

GREY METALLIC

SILVER METALLIC



SYMPHONY WHITE

## AXESS



WHITE



TEMPO BROWN

## STANDARD FABRIC SELECTION



UPHOLSTERY



SEWING STYLE



ZANNA



ZANNA



ZANNA

## OPTIONAL FABRIC SELECTION



LEATHER MATHISSE



LEATHER EDWARD



LEATHER MATHISSE



LEATHER EDWARD



\* With your choice of textile you can select any decorative cushion set.



LOW-PROFILE



# Blue-sky thinking.

The Coral, with its sky-line exterior profile, exclusive sky-roof and sky-lounge are the result of blue-sky thinking in designing a low profile motorhome. Luxury motorhomes delivering 'atrium-style living' for couples, with high levels of specification, comfort and practicality. Available in Supreme, Plus and Axess models, as a 2 or 3 berth motorhomes.

CORAL SUPREME



CORAL PLUS



CORAL AXESS



# CORAL RANGE

LOW-PROFILE





Coral, a motorhome designed around the exclusive sky-roof and sky-lounge, providing perfect comfort and practicality to in a wide choice of layouts and equipment levels, with layouts sleeping up-to 3 people.

## EXTERIOR FEATURES

1 . **'ADRIA COMPREX'** body construction.

2 . **SKY-LINE** exterior design with exclusive sky-roof.

3 . Choice of **BODY COLOURS** (silver on Supreme, white on Plus and Axess).

4 . **NEW REAR LED** lights (on Supreme).

5 . **WIDE 600 mm ENTRANCE DOOR.**

6 . **EASY ACCESS,** new garage design with power and new storage solutions.

7 . **SEITZ S4** framed windows (on Axess).



### 360° WALKTHROUGH

Step inside Coral, take a 360° Walkthrough on [www.adria.co.uk](http://www.adria.co.uk)

# INTERIOR FEATURES



**I** . Exclusive Sky-lounge and Sky-roof with integrated screening and ventilation.

**II** . Large dinette with Isofix and up-to 5 homologated seats.

**III** . Double floor with single level throughout and integrated storage.

**IV** . Contemporary interior design with choice of textiles and soft furnishings.

**V** . Multi-media wall and touch screen control panel.

**VI** . Choice of Truma or Alde heating.





## CORAL SUPREME / PLUS \_ Symphony White



## CORAL AXESS \_ Tempo Brown





CORAL  
SUPREME

CORAL  
PLUS



**Coral Supreme.** The ultimate semi-integrated motorhome, with silver alu-metallic body and the most luxurious interior and highest specifications. Symphony White interior design with new lighting and a choice of textiles and soft-furnishings.

**Coral Plus.** The mid-level semi-integrated motorhome with white body and choice of cabin colour. Luxury interior and high specifications. Symphony White interior design with new lighting and a choice of textiles and soft-furnishings.



SYMPHONY WHITE

Please note that right hand drive models are standard for the UK market.



CORAL  
AXESS



**Coral Axess.** The entry-level low profile motorhome with white body, contemporary interior and good specifications. Tempo Brown interior design with new lighting.





# CORAL LOW PROFILE

## Layouts

CORAL SUPREME

**670 DC** L (mm) 7503  
3 4 W (mm) 2299

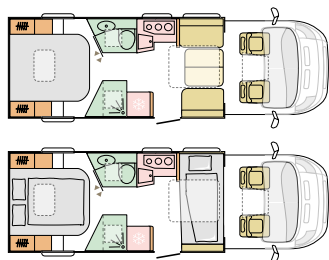

**670 DL** L (mm) 7503  
3 4 W (mm) 2299

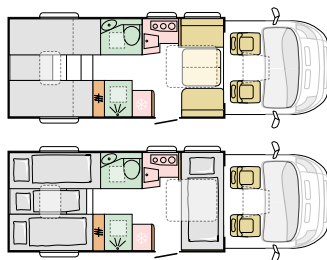

**670 SC** L (mm) 7503  
3 5 W (mm) 2299

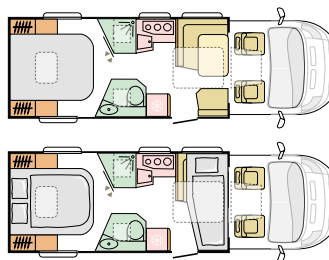

**670 SL** L (mm) 7503  
3 5 W (mm) 2299

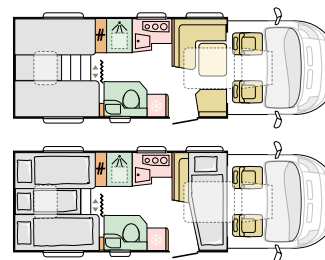

**670 SLT** L (mm) 7503  
3 5 W (mm) 2299

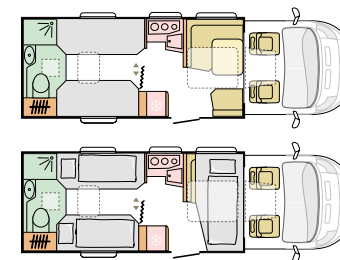

CORAL PLUS

**670 DC** L (mm) 7503  
3 4 W (mm) 2299

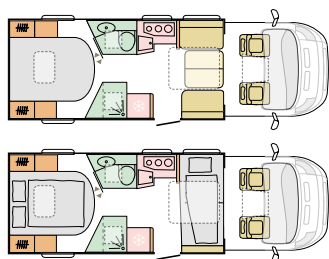

**670 DL** L (mm) 7503  
3 4 W (mm) 2299

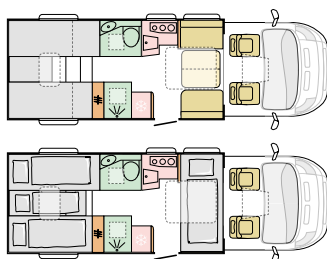

**670 SC** L (mm) 7503  
3 5 W (mm) 2299

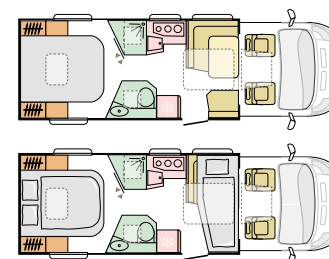

**670 SL** L (mm) 7503  
3 5 W (mm) 2299

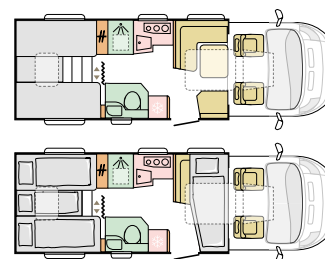

**670 SLT** L (mm) 7503  
3 5 W (mm) 2299

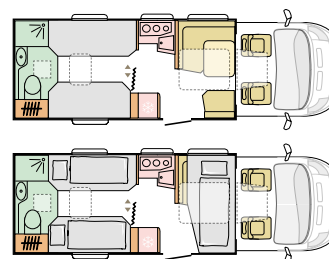

CORAL AXESS

**600 SL** L (mm) 6990  
2 4 W (mm) 2299

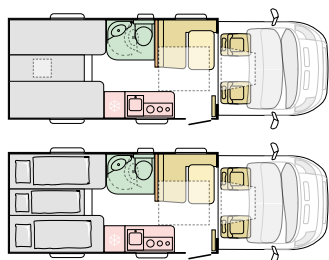

**670 SC** L (mm) 7503  
3 5 W (mm) 2299

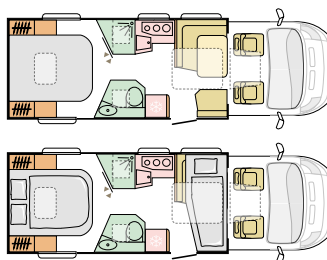

**670 SL** L (mm) 7503  
3 5 W (mm) 2299

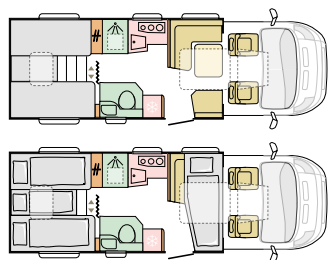

## Key data



**LENGTH** 7503 mm  
**WIDTH** 2299 mm  
**HEIGHT** 2850 mm  
**WEIGHT** 3500 - 4400 kg  
**ENGINE** 2,3 140 / 160 / 180 HP



or



\*available on  
Limited Edition  
models only

## Key features

- Adria 'Comprex' body construction, silver metallic alu body and sky roof panoramic.
- Adria exclusive sky-lounge and sky roof with integrated screening and ventilation.
- Symphony White interior design with choice of textiles and new soft furnishings.
- 'V design' kitchen with large fridge, 3 burner stove and oven.
- Spacious dinette on double floor with 5th homologated seat and optional Isofix.
- Multi-media wall and touch-screen control with TV holder.
- Alde Heating. Truma heating available on Limited Edition models only (ask your local dealer).
- Factory-fitted accessories options.

CORAL SUPREME



**LENGTH** 7503 mm  
**WIDTH** 2299 mm  
**HEIGHT** 2850 mm  
**WEIGHT** 3500 - 4400 kg  
**ENGINE** 2,3 140 / 160 / 180 HP



- Adria 'Comprex' body construction, white body and Sky-roof panoramic.
- Adria exclusive sky-lounge and sky roof with integrated screening and ventilation.
- Symphony White interior design with choice of textiles and new soft furnishings.
- 'V design' kitchen with large fridge, 3 burner stove and oven.
- Spacious dinette on double floor with 5th homologated seat and optional Isofix,
- Multi-media wall and touch-screen control with TV holder.
- Truma heating.
- Factory-fitted accessories options.

CORAL PLUS



**LENGTH** 6990 - 7503 mm  
**WIDTH** 2299 mm  
**HEIGHT** 2850 mm  
**WEIGHT** 3500 - 4000 kg  
**ENGINE** 2.3 / 140 / 160 / 180 HP



- Adria 'Comprex' body construction, white body and sky roof panoramic.
- Adria exclusive Sky-lounge and Sky-roof with integrated screening and ventilation.
- Tempo Brown interior design and new soft furnishings.
- 'V design' kitchen with large fridge, 3 burner stove and oven.
- Spacious dinette on double floor with 5th homologated seat and optional Isofix.
- Multi-media wall and touch-screen control with TV holder.
- Truma heating.
- Factory-fitted accessories options.

CORAL AXESS



# CORAL LOW PROFILE



EXTERIOR FINISHES



INTERIOR

## SUPREME



SILVER METALLIC



SYMPHONY WHITE

## PLUS



WHITE

GREY METALLIC

SILVER METALLIC



SYMPHONY WHITE

## AXESS



WHITE



TEMPO BROWN

## STANDARD FABRIC SELECTION



UPHOLSTERY



SEWING STYLE



ZANNA



ZANNA



ZANNA

## OPTIONAL FABRIC SELECTION



LEATHER MATHISSE



LEATHER EDWARD



LEATHER MATHISSE



LEATHER EDWARD



\* With your choice of textile you can select any decorative cushion set.



OVERCAB



# For extra-large adventures.

The Coral XL range sets the benchmark for stylish and practical “over cab” motorhomes. Sleek lines and spacious practical interiors with up-to 7 homologated seats, making them perfect for large families and groups. Available in Plus models, in 2 layouts, sleeping up to 6 people.

CORAL XL PLUS





# CORAL X RANGE

OVERCAB





## EXTERIOR FEATURES

1 . **ADRIA 'COMPREX'** body construction.

2 . **LARGE OVER-CAB** profile with panoramic roof window.

3 . **AUTOMOTIVE SIDE-SKIRT** with optional cabin step.

4 . **WHITE BODY** with choice of **CABIN EXTERIOR COLOUR**.

5 . **DYNAMIC REAR WALL** design with new rear LED lights.

6 . **WIDE 600 mm ENTRANCE** door and two side windows.

7 . **EASY ACCESS**, new garage design with power and new storage solutions.

8 . **SEITZ S4** framed windows.



### 360° WALKTHROUGH

Step inside Coral XL, take a 360° Walkthrough on [www.adria.co.uk](http://www.adria.co.uk)

# INTERIOR FEATURES

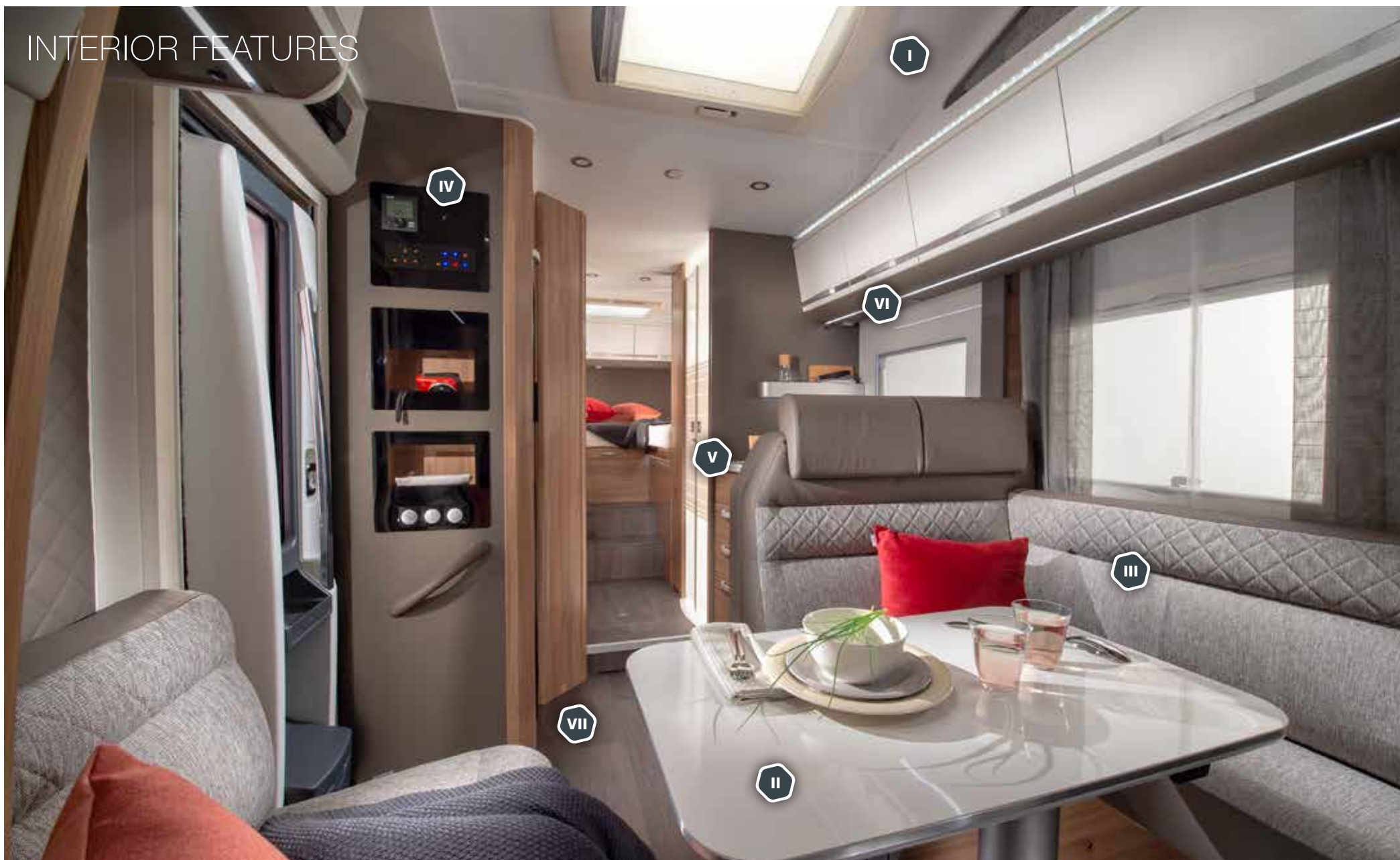

**I** . Light frame front lift-down bed, with panoramic window.

**II** . Large dinette with up-to 7 homologated seats and optional Isofix.

**III** . Contemporary interior design with choice of textiles and soft furnishings.

**IV** . Multi-media wall and touch screen control panel.

**V** . Smart kitchen with slim tower fridge and all functionalities.

**VI** . Spacious interior with new lighting and storage solutions throughout.

**VII** . Truma heating.



CORAL XL  
PLUS



**Coral XL Plus.** The top of the XL range, with white body and choice of cabin colour. Contemporary interior and high specifications. Symphony White interior design with new lighting and a choice of textiles and soft-furnishings.



SYMPHONY WHITE

Please note that right hand drive models are standard for the UK market.



# CORAL XL OVERCAB

## Layouts

<b>600 DP</b>	L (mm) <b>6990</b>	<b>670 SP</b>	L (mm) <b>7320</b>
6  6	W (mm) <b>2299</b>	6  5	W (mm) <b>2299</b>

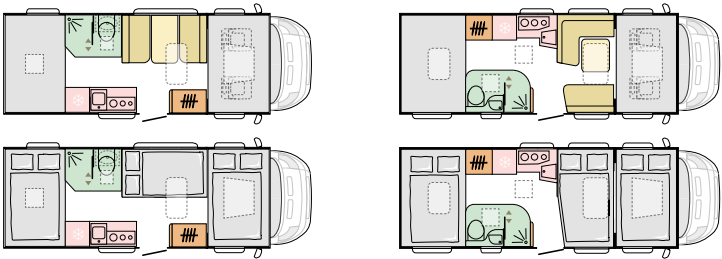

L = Length W = Width

Number of Berths Number of Seats Kitchen Table Seating area Wardrobe Berths Bathroom Floor



EXTERIOR FINISHES

- WHITE
- GREY METALLIC
- SILVER METALLIC



INTERIOR



## Key data



**LENGTH** 6990 - 7320 mm  
**WIDTH** 2299 mm  
**HEIGHT** 3070 mm  
**WEIGHT** 3500 - 4400 kg  
**ENGINE** 2,3 140 / 160 / 180 HP



## Key features

- Adria 'Complex' body construction, White body and sleek over-cab bedroom.
- Symphony White interior design with choice of textiles and new soft furnishings.
- Smart kitchen with 3 burner stove, sink, slim tower fridge and oven.
- Multi-media wall and touch-screen control with TV holder.
- Large dinette with up to 6 homologated seats.
- New lighting and garage design with lighting, power & new storage solutions.
- Truma Heating.
- Factory-fitted accessories options.

CORAL XL PLUS

## STANDARD FABRIC SELECTION



UPHOLSTERY



SEWING STYLE



ZANNA

## OPTIONAL FABRIC SELECTION



LEATHER MATHISSE



LEATHER EDWARD



COMPACT



# New Compact 2020. Go anywhere!

The new Compact, with slim-fit and short length dimensions for an agile motorhome, which can reach more places. New Supreme models with 'silver' body and exclusive new Sky-roof and Sky-lounge. All models with contemporary new interiors, high levels of specification, comfort and practicality. Available in new Supreme and Plus models with 2 layouts, sleeping up-to 3 people.

COMPACT SUPREME



COMPACT PLUS



# COMPACT RANGE

COMPACT





# COMPACT

Compact, the perfect motorhome for up-to three people. Easy to use, can go almost anywhere, with outstanding comfort and practicality. Available in new Supreme and Plus models on the Fiat Ducato, with a choice of layouts and equipment.

## EXTERIOR FEATURES

- 1 . **ADRIA 'COMPREX'** body construction.
- 2 . **NEW DESIGN** aerodynamic cap with exclusive Sky-roof panoramic window.
- 3 . **'SILVER' BODY** (Supreme) or white body (Plus).
- 4 . **DYNAMIC REAR WALL** design with new rear LED lights.
- 5 . **SLIM-FIT EXTERIOR** with body width 2,12 m.
- 6 . **EASY ACCESS**, new garage design with power and new storage solutions.
- 7 . **AUTOMOTIVE SIDE** skirts.



### 360° WALKTHROUGH

Step inside Compact, take a 360° Walkthrough on [www.adria.co.uk](http://www.adria.co.uk)

# INTERIOR FEATURES



**I** . New Sandy White or Sandy Brown interior design with choice of soft furnishings.

**II** . Dinette on double floor, with heating and optional Isofix.

**III** . New Smart kitchen with large fridge and all functionalities.

**IV** . New Duplex bathroom with swivel-shower wall.

**V** . Spacious interior with new lighting and storage solutions throughout.

**VI** . Truma heating.



COMPACT  
SUPREME

COMPACT  
PLUS



**Compact Supreme.** The top of the range, with 'silver' body. New contemporary interior and high specifications. Sandy White new interior design with a choice of textiles and soft-furnishings.

**Compact Plus.** Well-equipped with white body and optional grey cabin. New contemporary interior and high specifications. New Sandy White interior design with a choice of textiles and soft-furnishings.



Please note that right hand drive models are standard for the UK market.



# COMPACT

## Layouts

COMPACT SUPREME

**DL** L (mm) **6990**  
**3** **4** W (mm) **2120**

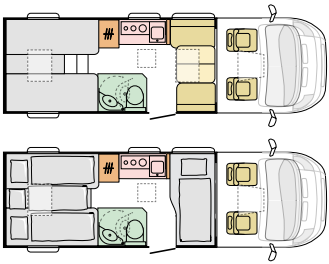

**SP** L (mm) **5999**  
**3** **4** W (mm) **2120**

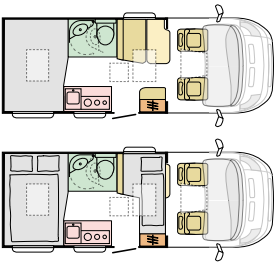

COMPACT PLUS

**DL** L (mm) **6990**  
**3** **4** W (mm) **2120**

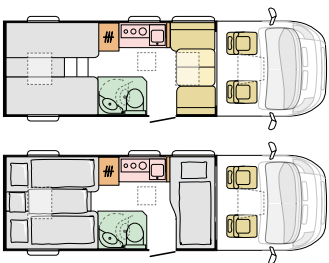

**SP** L (mm) **5999**  
**3** **4** W (mm) **2120**

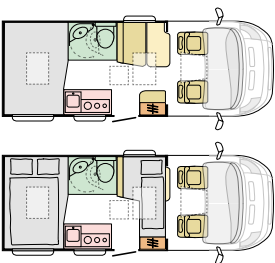

L = Length W = Width

## Key data



**LENGTH** 5999 - 6990 mm  
**WIDTH** 2120 mm  
**HEIGHT** 2750 mm  
**WEIGHT** 3500 kg  
**ENGINE** 2,3 140 / 160 / 180 HP



## Key features

- Adria 'Comprex' body construction, with 'silver' body.
- New exclusive Sky-roof panoramic window and Sky-lounge.
- New interior design in Sandy White with a choice of textiles.
- New Smart kitchen with 3 burner stove, sink, slim tower fridge and oven (on DL layout).
- Dinette on double floor, with heating and optional Isofix.
- New lighting and garage design.
- Truma heating.
- Factory-fitted accessories options.

COMPACT SUPREME



**LENGTH** 5999 - 6990 mm  
**WIDTH** 2120 mm  
**HEIGHT** 2750 - 2780 mm  
**WEIGHT** 3500 kg  
**ENGINE** 2,3 140 / 160 / 180 HP



- Adria 'Comprex' body construction, with white body, optional Grey
- New exclusive Sky-roof panoramic window and Sky-lounge.
- New interior design in Sandy White with a choice of textiles.
- New Smart kitchen with 3 burner stove, sink, slim tower fridge and oven (on DL layout).
- Dinette on double floor, with heating and optional Isofix.
- New lighting and garage design.
- Truma heating.
- Factory-fitted accessories options.

COMPACT PLUS



# COMPACT



EXTERIOR FINISHES



INTERIOR

## SUPREME



SILVER METALLIC



SANDY WHITE

## PLUS



WHITE

GREY METALLIC

SILVER METALLIC



SANDY WHITE

STANDARD FABRIC SELECTION



UPHOLSTERY



SEWING STYLE



ZANNA



ZANNA

OPTIONAL FABRIC SELECTION



LEATHER MATHISSE



LEATHER EDWARD



LEATHER MATHISSE



LEATHER EDWARD



\* With your choice of textile you can select any decorative cushion set.



# It's never just a chair

We've redesigned our seating for more comfort and more support. After all during every great adventure you need to relax.

# Soft furnishings

New for season 2020, you can now choose new soft furnishings, from a brilliant repertoire of cushions to add a bit more personality.

## SEWING STYLE

The beauty is in the details. Precision sewn in different styles to suit your taste.

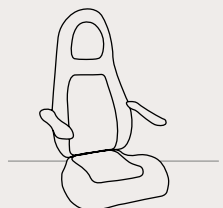
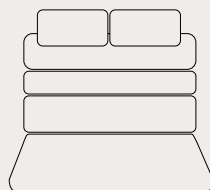
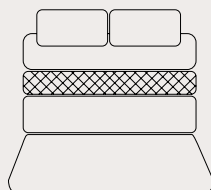
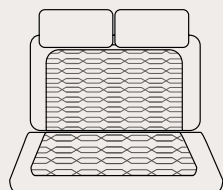

**SONIC**

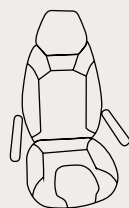

**MATRIX \_ CORAL**



**COMPACT**

## CUSHION TEXTILES



**SOPHISTICATED  
CLASSIC**



**VIOLET CHICK**

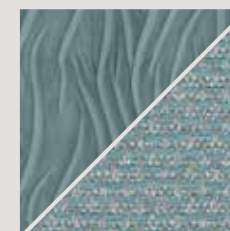

**OCEAN SERENITY**



**AUTUMN CALMNESS**

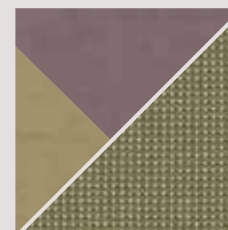

**SPRING GARDEN**

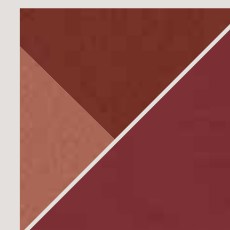

**CHERRY PUNCH**

# Ready to Go



**NEW ACCESSORIES** For any adventure you always need additional equipment! Adria now supplies optional accessories, using the top brands. This new program can be ordered at your Adria dealer and applies to most 2020 motorhomes.

Ready to go accessories include the following options:

## AWNINGS



## ROOF MOUNTED AIR CONDITIONING



## SOLAR PANELS



## BIKE RACK PRE-INSTALLATION



Go to [www.adria.co.uk](http://www.adria.co.uk) for more information and vehicle applicability.



# Why choose Adria?



## MULTIPLE WINNER OF MANY INDUSTRY AWARDS

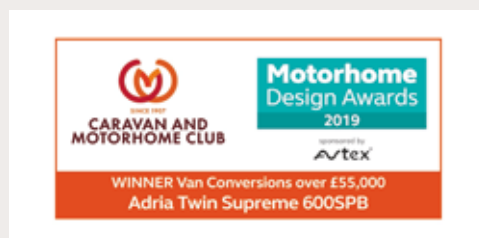

## WATER INGRESS WARRANTY

Adria vehicles now offer a 10 year water ingress warranty as standard, reflecting the superiority of this unique form of body construction.

\*Terms and conditions apply, please see [www.adria.co.uk](http://www.adria.co.uk) for details.



### **30 DEALERSHIPS AND OVER 90 SERVICE CENTRES IN THE UK**

Adria provides total customer experience service and support through our dealer network of skilled and experienced dealerships and service centres.



### **ALL VEHICLES ARE DESIGNED SPECIFICALLY FOR THE UK**

Adria selects and works closely with the factory to ensure the optimum selection of caravans and motorhomes, features and layouts are available and tailored to the preferences of the UK customer needs and requirements.



### **MANUFACTURING LEISURE VEHICLES FOR OVER 54 YEARS**

Adria has over 54 years of experience in recreational design and manufacture, which brings many advantages in terms of quality, attention to detail and offers a wide choice of vehicles, features and layouts.



### **ALL VEHICLES ARE FULLY WINTERISED FOR ALL-YEAR USE**

Adria optimises the heating efficiency of all vehicles with precise engineering and cold chamber testing. This approach combined with Adria 'Comprex' construction and the best insulation enables the elimination of thermal bridges for an efficient, comfortable environment, all year round.



### **OVER 500 DEALERS WORLDWIDE**

Adria offers peace of mind holidays with extensive coverage of dealerships throughout Europe and beyond.



## WORLD-CLASS PARTNERS

### ACCEPT NO COMPROMISES

**TINA MAZE.** Double World Champion and double Olympic gold medallist. One of the best skiers of all time, Tina Maze, from Slovenia, uses her Sonic with her new family, following the snow for skiing and wind, for windsurfing.



### LIVING IN MOTION

**PRIMOŽ ROGLIČ.**

Slovene, a world-class cyclist, fourth in the 2018 Tour de France and third in the Giro d'Italia 2019.

#### **ADRIA MOBIL CYCLING TEAM.**

The Adria-Mobil Cycling Team are the top Slovenian cycling team in the UCI European Tour. For more information visit [www.adria-mobil-cycling.com](http://www.adria-mobil-cycling.com)







## EXTREME PERFORMANCE

**JAKOV FAK.** Silver medal biathlon winner at the 2018 Winter Olympics and Bronze in Vancouver in 2010, is an Adria ambassador.

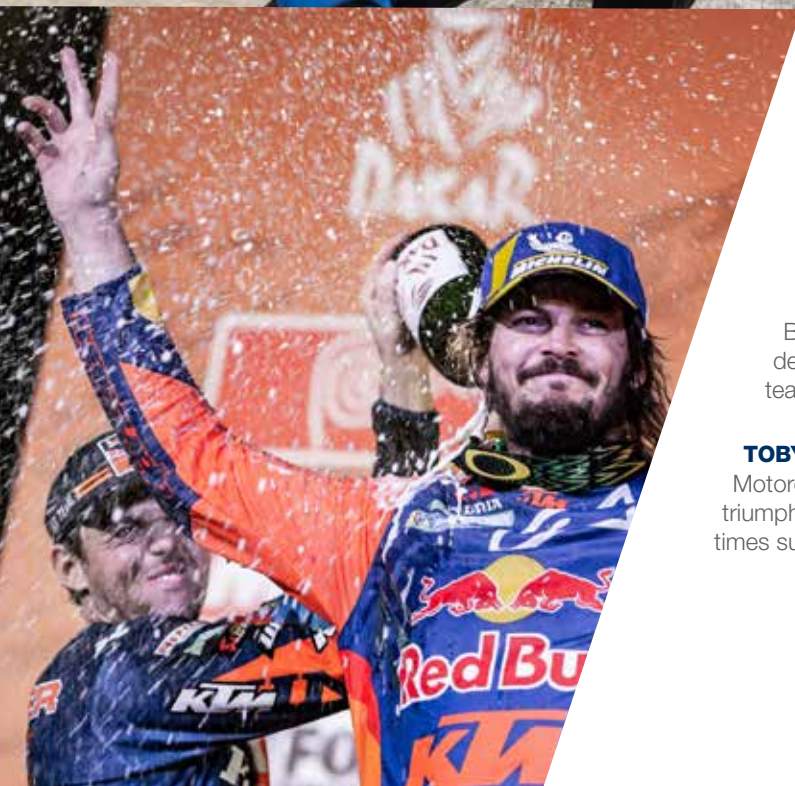

## TAKEN TO EXTREMES

**KTM.** Every January since 2013, a fleet of Adria Sonic and Matrix motorhomes are taken on the Dakar Rally in South America by Red Bull KTM Factory Racing. Custom-designed Adria Twins also support their team's MXGP World Championship.

**TOBY PRICE.** 2019 Dakar Rally Motorcycle Winner. KTM's eighteenth triumph at the annual Dakar rally, seven times supported by Adria motorhomes.

ADRIA CONCESSIONAIRES LTD.  
Drury drive  
Sudbury  
Suffolk  
CO10 1WH  
Tel. +44(0)1787 888 980  
Email: [info@adria.co.uk](mailto:info@adria.co.uk)  
Website: [www.adria.co.uk](http://www.adria.co.uk)

**Slovenia.** Your caravanning destination.  
[www.slovenia.info](http://www.slovenia.info)



The purpose of the catalogue is illustrative. Pictures inside the catalogue may include some elements not belonging to standard equipment or portray products belonging to different markets. Products may change from technical or commercial points of view in respect of regulations. Please contact your selected Dealer to obtain detailed information before purchasing.

Published by: Adria Mobil, d.o.o.; Art Direction: Pubblimarket2; Production: Enigma d.o.o.; Photography: Branko Čeak, Jože Maček, Jure Horvat, Styling: Nataša Mandelj Čeak; Lifestyle photos: Daniele Molineris, Luca Masarà, Shutterstock, iStock, themediumgray.com; Styling: Claudia Barberi, Pubblimarket2; KTM Images: photo Dakar Toby Price: Marcin Kin; photo Cairol: Bavo Swijgers; Photo Adria Mobil Cycling: Vid Ponikvar/Sportida; Renders: Inpac d.o.o.; Copy: Neil Morley; Lythography: Tomo Per; Thanks to: Fjäll Räven, Gazèl, Fiascaris, Cmp, Mueller, Amfibija; Printed by: Printera Grupa d.o.o.